

STUDLANDS PARK AVENUE

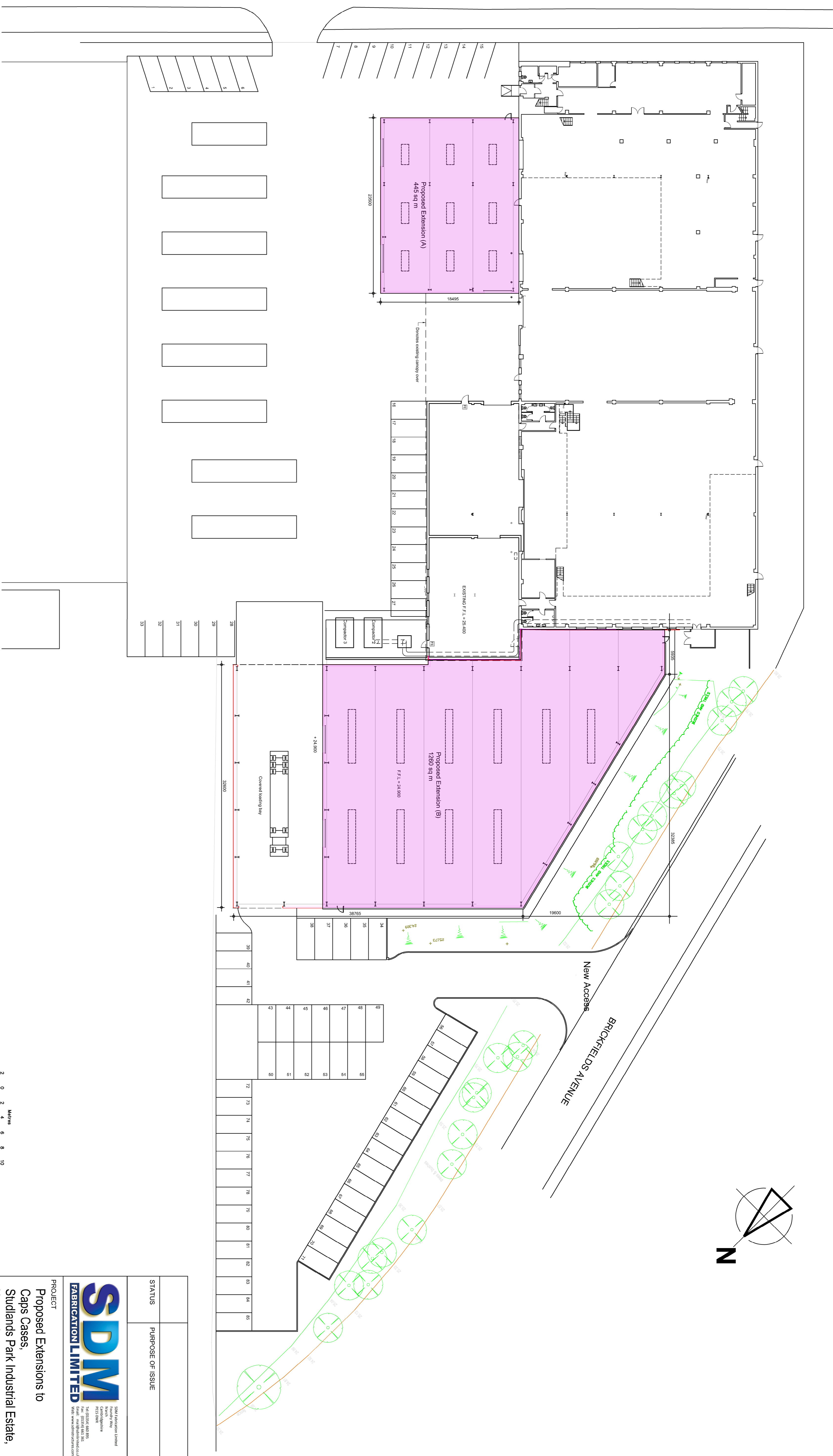

Proposed Site Plan (1:250)

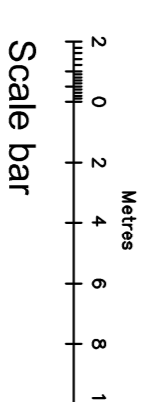

STATUS		PURPOSE OF ISSUE	
<p><b>SDM</b>          FABRICATION LIMITED          2004 Park Road, Lymington, Hampshire, PO15 0WN, UK          Tel: 01534 664888, Fax: 01534 664889          Email: sales@sdmlimited.co.uk, Web: www.sdmlimited.com</p>			
<p>PROJECT          Proposed Extensions to          Caps Cases,          Studlands Park Industrial Estate,          Newmarket,          Suffolk CB8 7AU</p>			
TITLE Proposed Site Plan			
CLIENT	Caps Cases	DATE	10/10/2016
DRAWN BY	MAW	CHECKED BY	
SCALE (@ A1)	1:250	PROJECT NUMBER	3875
DRAWING NUMBER	3875 - 004	REV	